

Land Surveyed for the Proprietaries

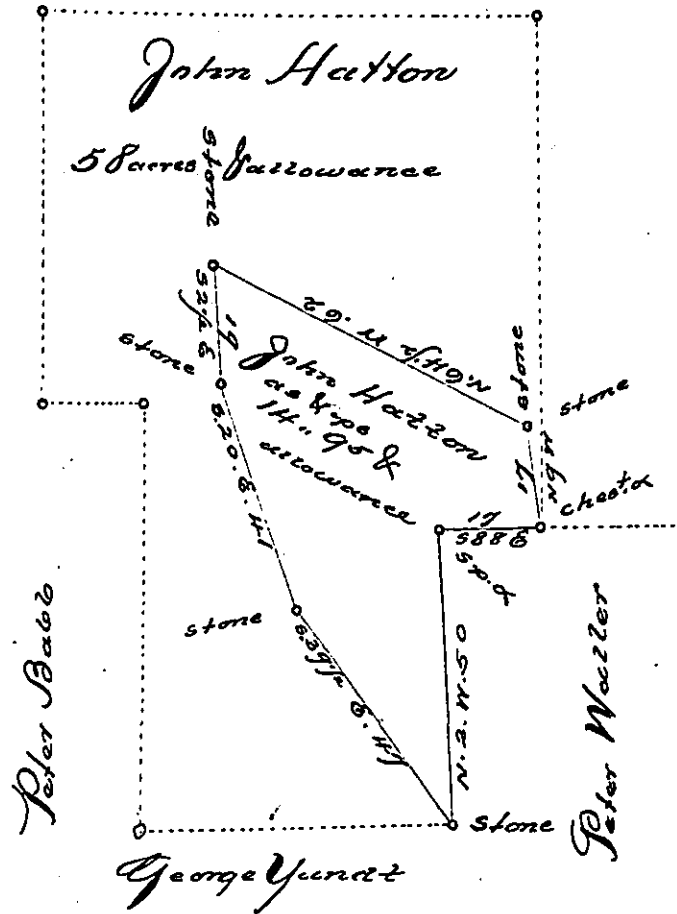

A Draught of a tract of land situated in Brecknock township in the County of Lancaster. Containing fourteen acres & nine & five perches & allowance of six per cent $\frac{1}{2}$. Surveyed to John Hutton on application No. 2302. dated the 2^d Day of February Anno Domini Sixty seven. being part of 58 acres & allowance of six per cent $\frac{1}{2}$. Surveyed the 10th Day of August A. D. 1812 for

John Stephenson

Dr. Jacob Hiskman M.D.

To Andrew Porter Esq^r
 Surveyor General

IN TESTIMONY that the above is a copy of the original remaining on file in the Department of Internal Affairs of Pennsylvania, made conformably to an Act of Assembly approved the 16th day of February, 1833, I have hereunto set my Hand and caused the Seal of said Department to be affixed at Harrisburg, this first day of November 1898,

James W. Fatta
 Secretary of Internal Affairs.